

# Technical data sheet



## Product features

### Cooling counter 2x2 drawer

<b>Model</b>	<b>SAP Code</b>	00013324
--------------	-----------------	----------



- Material: Stainless steel
- GN / EN size in device: GN 1/1
- Number of GN / EN: 4
- Number of drawers: 4
- Control type: Digital
- Minimum device temperature [°C]: 2
- Maximum device temperature [°C]: 8
- Insulation thickness [mm]: 35
- Unit: Down
- Automatic defrost: Yes

<b>SAP Code</b>	00013324	<b>Number of drawers</b>	4
<b>Net Width [mm]</b>	900	<b>Number of GN / EN</b>	4
<b>Net Depth [mm]</b>	700	<b>GN / EN size in device</b>	GN 1/1
<b>Net Height [mm]</b>	880	<b>GN device depth</b>	150
<b>Net Weight [kg]</b>	89.00	<b>Minimum device temperature [°C]</b>	2
<b>Power electric [kW]</b>	0.200	<b>Maximum device temperature [°C]</b>	8
<b>Loading</b>	230 V / 1N - 50 Hz	<b>Refrigerant</b>	R290
<b>Energy class</b>	C	<b>Worktop material</b>	SS201
<b>Chamber volume [l]</b>	166	<b>Refrigerant weight [g]</b>	80.00

# Technical data sheet



Technical drawing

Cooling counter 2x2 drawer

Model

SAP Code

00013324

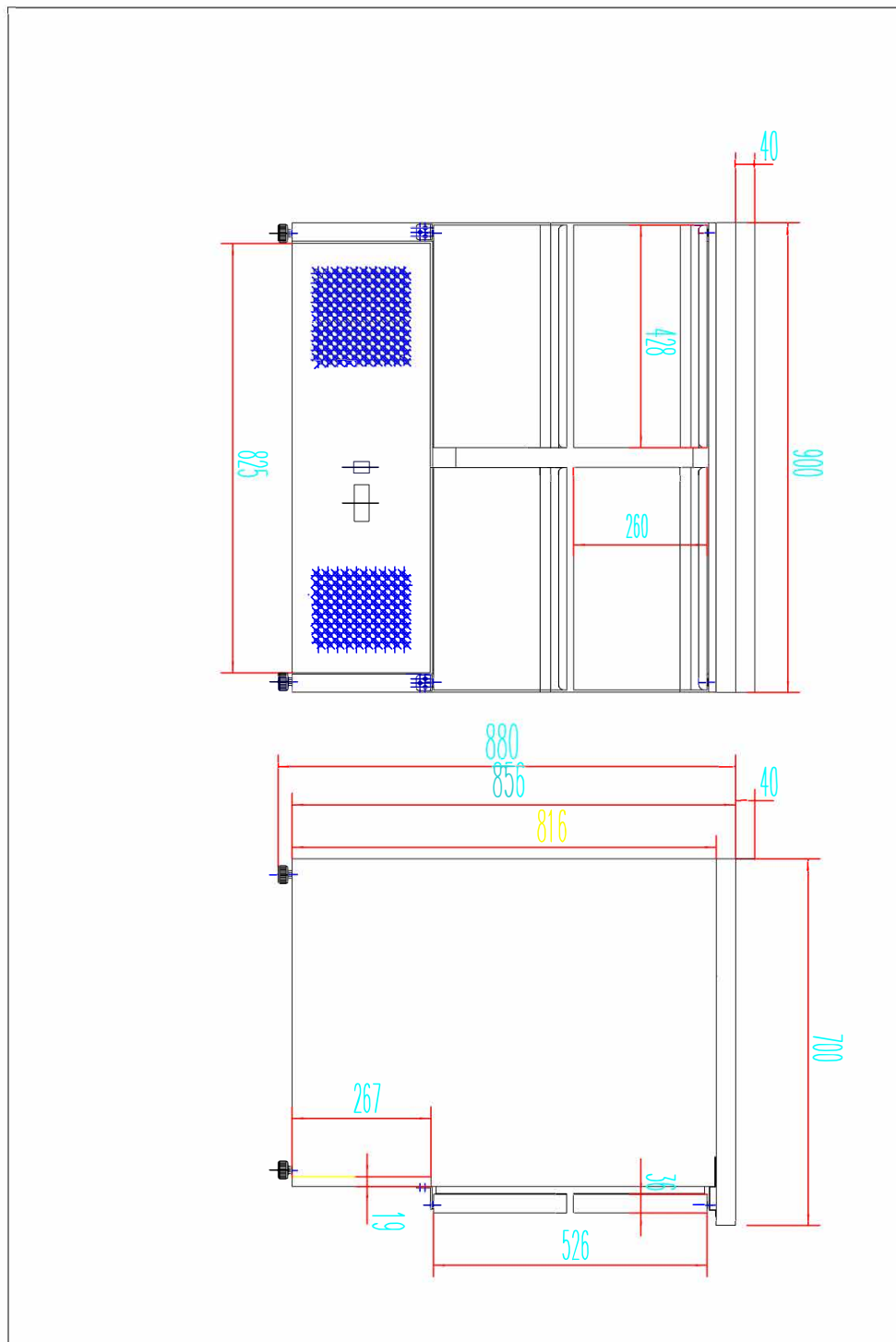

# Technical data sheet



## Technical parameters

### Cooling counter 2x2 drawer

Model

SAP Code

00013324

**1. SAP Code:**

00013324

**2. Net Width [mm]:**

900

**3. Net Depth [mm]:**

700

**4. Net Height [mm]:**

880

**5. Net Weight [kg]:**

89.00

**6. Gross Width [mm]:**

970

**7. Gross depth [mm]:**

765

**8. Gross Height [mm]:**

1095

**9. Gross Weight [kg]:**

99.00

**10. Device type:**

Electric unit

**11. Power electric [kW]:**

0.200

**12. Loading:**

230 V / 1N - 50 Hz

**13. Energy class:**

C

**14. Refrigerant:**

R290

**15. Cooling type:**

Static

**16. Material:**

Stainless steel

**17. Device color:**

Stainless steel

**18. Device properties 2:**

Cooling

**19. GN / EN size in device:**

GN 1/1

**20. Number of internal parts:**

4

**21. Number of GN / EN:**

4

**22. GN device depth:**

150

**23. Chamber volume [l]:**

166

**24. Worktop material:**

SS201

**25. Insulation thickness [mm]:**

35

**26. Number of drawers:**

4

**27. Unit:**

Down

**28. Control type:**

Digital

# Technical data sheet



Technical parameters

Cooling counter 2x2 drawer

Model

SAP Code

00013324

**29. Annual energy consumption [kWh]:**

883

**32. Automatic defrost:**

Yes

**30. Minimum device temperature [°C]:**

2

**33. Refrigerant weight [g]:**

80.00

**31. Maximum device temperature [°C]:**

8